



Description

JMT N-channel Enhancement Mode Power MOSFET

Features

- 20V, 0.75A
 $R_{DS(ON)} < 165m\Omega @ V_{GS} = 4.5V$
 $R_{DS(ON)} < 260m\Omega @ V_{GS} = 2.5V$
- Advanced Trench Technology
- Excellent $R_{DS(ON)}$ and Low Gate Charge
- Lead free product is acquired
- ESD Protected: 2KV

Application

- Load Switch
- PWM Application
- Power management



DFN1006-3L top view

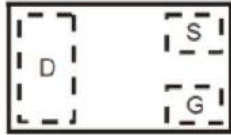

Marking and pin Assignment

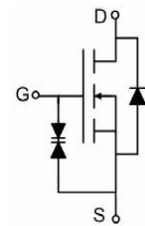

Schematic Diagram

Package Marking and Ordering Information

Device Marking	Device	OUTLINE	Device Package	Reel Size	Reel (PCS)	Per Carton (PCS)
34K	JMTD3134K	TAPING	DFN1006-3L	7inch	10000	400000

Absolute Maximum Ratings (T_A=25°C unless otherwise specified)

Symbol	Parameter	Max.	Units
V _{DSS}	Drain-Source Voltage	20	V
V _{GSS}	Gate-Source Voltage	±10	V
I _D	Continuous Drain Current	T _A = 25°C	0.75
		T _A = 100°C	0.5
I _{DM}	Pulsed Drain Current ^{note1}	3	A
P _D	Power Dissipation	T _A = 25°C	0.15
R _{θJA}	Thermal Resistance, Junction to Case	833	°C/W
T _J , T _{STG}	Operating and Storage Temperature Range	-55 to +150	°C



Electrical Characteristics (T_J=25°C unless otherwise specified)

Symbol	Parameter	Test Condition	Min.	Typ.	Max.	Units
Off Characteristic						
V _{(BR)DSS}	Drain-Source Breakdown Voltage	V _{GS} =0V, I _D =250μA	20	-	-	V
I _{DSS}	Zero Gate Voltage Drain Current	V _{DS} =20V, V _{GS} =0V,	-	-	1	μA
I _{GSS}	Gate to Body Leakage Current	V _{DS} =0V, V _{GS} = ±10V	-	-	±10	uA
On Characteristics						
V _{GS(th)}	Gate Threshold Voltage	V _{DS} =V _{GS} , I _D =250μA	0.4	0.7	1.0	V
R _{DS(on)}	Static Drain-Source on-Resistance <small>note2</small>	V _{GS} =4.5V, I _D =0.5A	-	125	165	mΩ
		V _{GS} =2.5V, I _D =0.4A	-	185	260	
Dynamic Characteristics						
C _{iss}	Input Capacitance	V _{DS} =10V, V _{GS} =0V, f=1.0MHz	-	60	-	pF
C _{oss}	Output Capacitance		-	22	-	pF
C _{rss}	Reverse Transfer Capacitance		-	12	-	pF
Q _g	Total Gate Charge	V _{DS} =10V, I _D =0.75A, V _{GS} =4.5V	-	1	-	nC
Q _{gs}	Gate-Source Charge		-	0.28	-	nC
Q _{gd}	Gate-Drain("Miller") Charge		-	0.22	-	nC
Switching Characteristics						
t _{d(on)}	Turn-on Delay Time	V _{DS} =10V, I _D =0.5A, R _{GEN} =10Ω, V _{GS} =4.5V	-	2	-	ns
t _r	Turn-on Rise Time		-	19	-	ns
t _{d(off)}	Turn-off Delay Time		-	10	-	ns
t _f	Turn-off Fall Time		-	23	-	ns
Drain-Source Diode Characteristics and Maximum Ratings						
I _S	Maximum Continuous Drain to Source Diode Forward Current		-	-	0.75	A
I _{SM}	Maximum Pulsed Drain to Source Diode Forward Current		-	-	3	A
V _{SD}	Drain to Source Diode Forward Voltage	V _{GS} =0V, I _S =0.75A	-	-	1.2	V

Notes:1. Repetitive Rating: Pulse Width Limited by Maximum Junction Temperature

2. Pulse Test: Pulse Width≤300μs, Duty Cycle≤0.5%



Typical Performance Characteristics

Figure 1: Output Characteristics

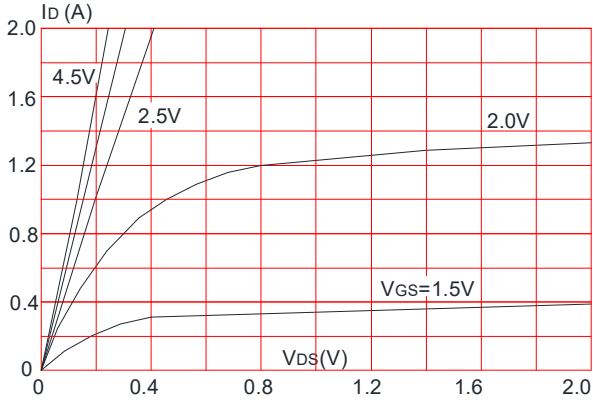

Figure 2: Typical Transfer Characteristics

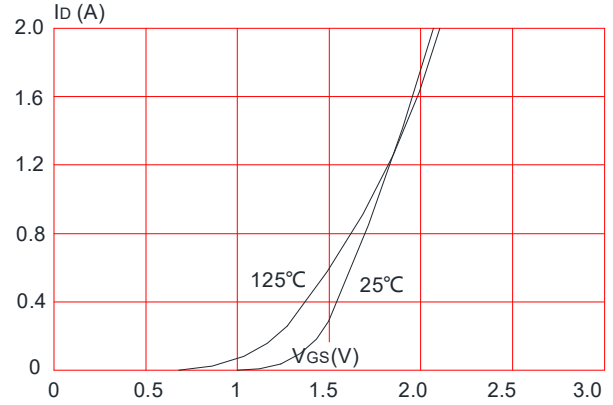

Figure 3: On-resistance vs. Drain Current

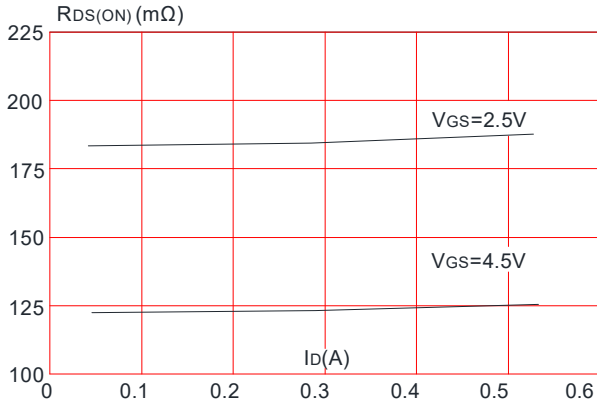

Figure 4: Body Diode Characteristics

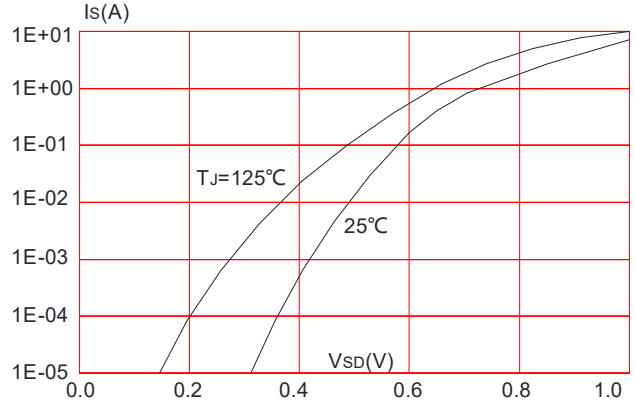

Figure 5: Gate Charge Characteristics

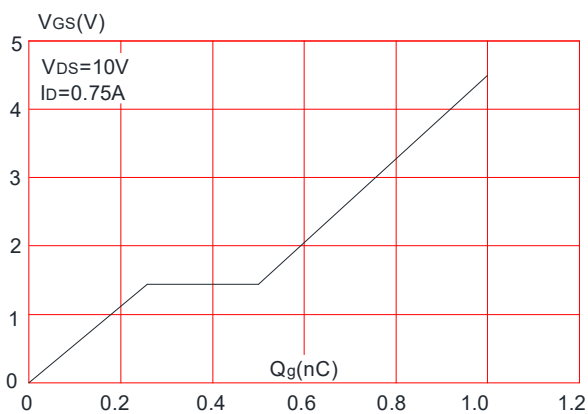

Figure 6: Capacitance Characteristics

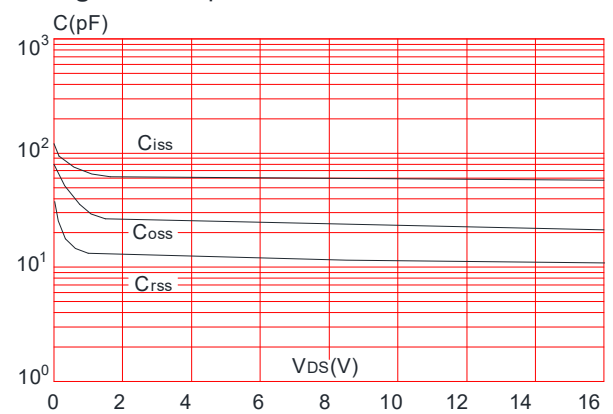



Figure 7: Normalized Breakdown Voltage vs. Junction Temperature

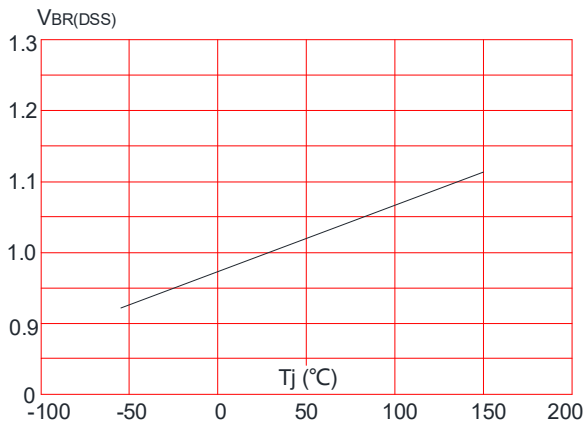

Figure 8: Normalized on Resistance vs. Junction Temperature

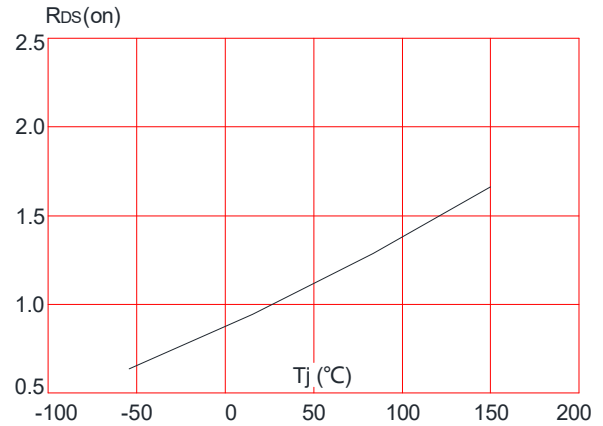

Figure 9: Maximum Safe Operating Area

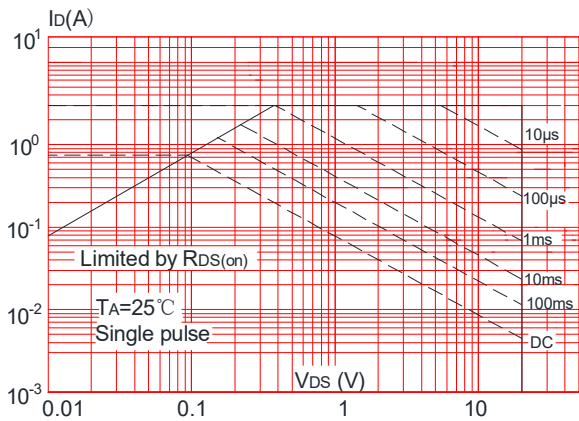

Figure 10: Maximum Continuous Drain Current vs. Ambient Temperature

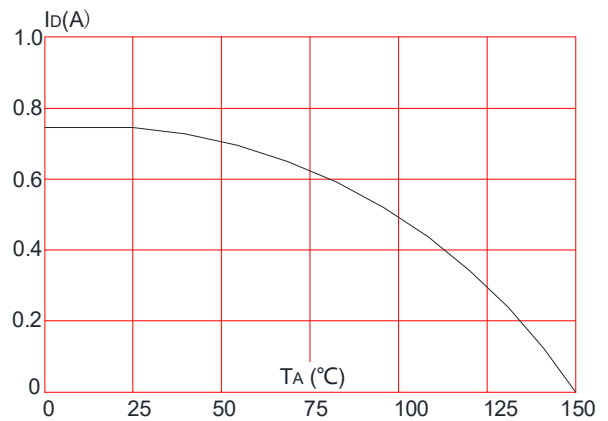
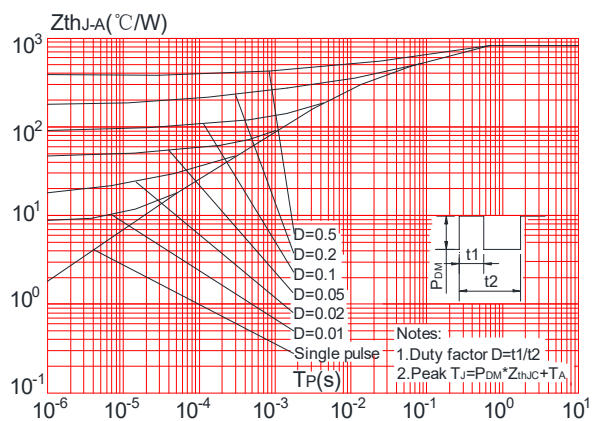

Figure 11: Maximum Effective Transient Thermal Impedance, Junction-to-Ambient



Test Circuit

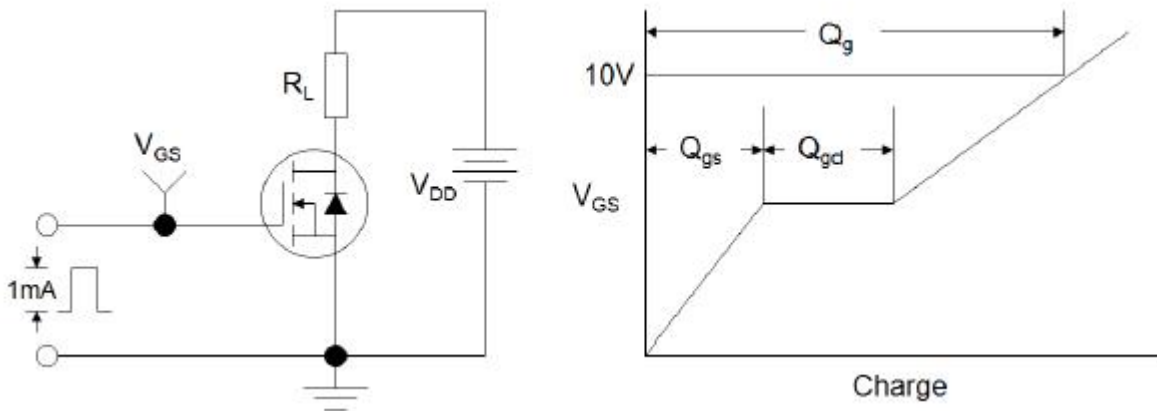

Figure1:Gate Charge Test Circuit & Waveform

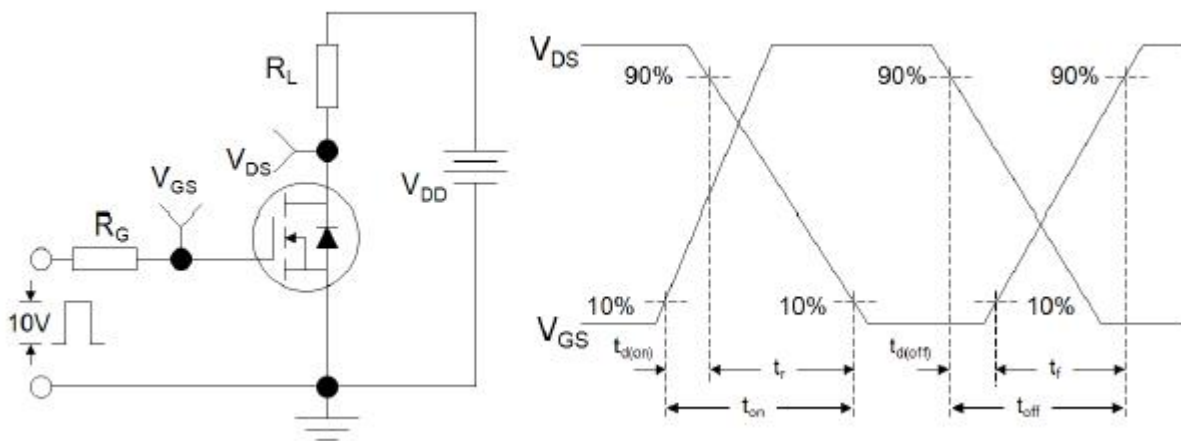

Figure 2: Resistive Switching Test Circuit & Waveforms

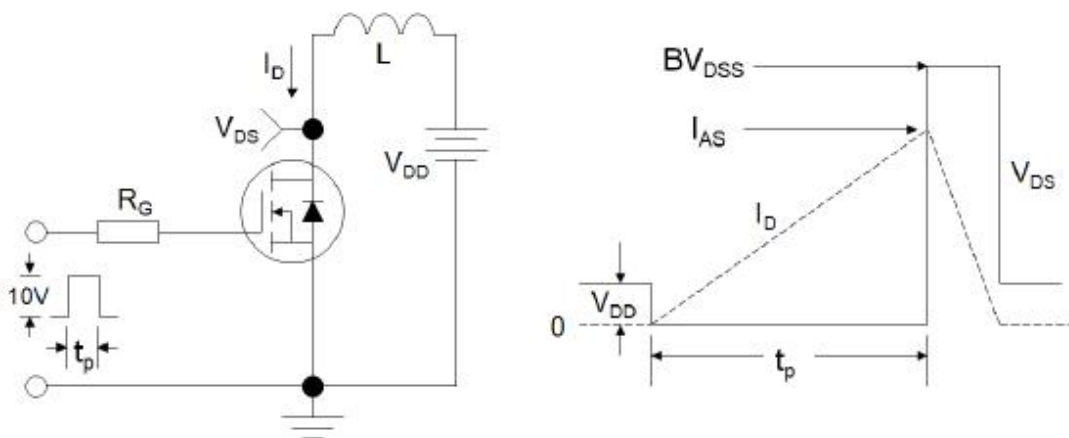
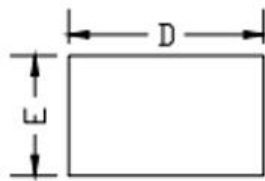

Figure 3:Unclamped Inductive Switching Test Circuit & Waveforms



Package Mechanical Data-DFN1006-3L



TOP VIEW

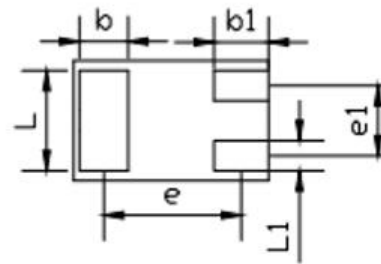

BOTTOM VIEW

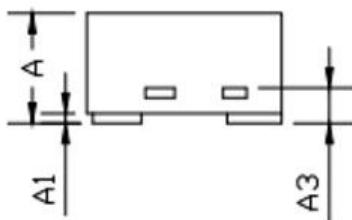

SIDE VIEW

COMMON DIMENSION (MM)			
PKG	DFN1006		
REF.	MIN.	NDM.	MAX
A	>0.4	-	0.50
A1	0.00	-	0.05
A3	0.127REF.		
D	0.95	1.00	1.05
E	0.55	0.60	0.65
b	0.20	0.25	0.30
b1	0.20	0.30	0.40
L	0.45	0.50	0.55
L1	0.10	0.15	0.20
e	0.675		
e1	0.35		

Information furnished in this document is believed to be accurate and reliable. However, Jiangsu JieJie Microelectronics Co.,Ltd assumes no responsibility for the consequences of use without consideration for such information nor use beyond it.

Information mentioned in this document is subject to change without notice, apart from that when an agreement is signed, Jiangsu JieJie complies with the agreement.

Products and information provided in this document have no infringement of patents. Jiangsu JieJie assumes no responsibility for any infringement of other rights of third parties which may result from the use of such products and information.

This document supersedes and replaces all information previously supplied.

 is a registered trademark of Jiangsu JieJie Microelectronics Co.,Ltd.
Copyright ©2022 Jiangsu JieJie Microelectronics Co.,Ltd. Printed All rights reserved.