



-60V 40mΩ P-Ch Power MOSFET

Features

- Low Gate Charge
- 100% UIS Tested, 100% R_g Tested
- Pb-free Lead Plating
- Halogen-free and RoHS-compliant

Product Summary

Parameter	Value	Unit
V _{DS}	-60	V
V _{GS(th)_Typ}	-2.0	V
I _D (@ V _{GS} = -10V) ⁽¹⁾	-22	A
R _{DS(ON)_Typ} (@ V _{GS} = -10V)	40	mΩ
R _{DS(ON)_Typ} (@ V _{GS} = -4.5V)	55	mΩ

Applications

- LED Back-lighting Application
- DC/DC Power Management
- High Side Switch for Full Bridge Converter

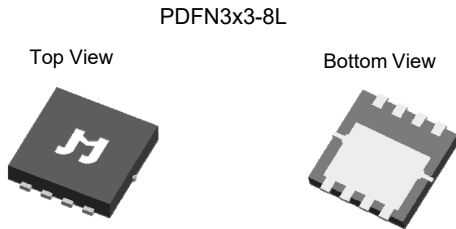

Pin Configuration
Top View

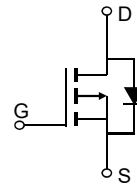
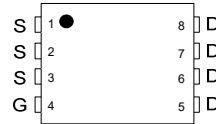

Ordering Information

Device	Package	# of Pins	Marking	MSL	T _J (°C)	Media	Quantity (pcs)
JMPL0648AU-13	PDFN3x3-8L	8	PL0648A	1	-55 to 150	13-inch Reel	5000

Absolute Maximum Ratings (@ T_A = 25°C unless otherwise specified)

Parameter	Symbol	Value	Unit
Drain-to-Source Voltage	V _{DS}	-60	V
Gate-to-Source Voltage	V _{GS}	±20	V
Continuous Drain Current ⁽¹⁾	I _D	T _C = 25°C	-22
		T _C = 100°C	-14.2
Pulsed Drain Current ⁽²⁾	I _{DM}	-70	A
Avalanche Energy ⁽³⁾	E _{AS}	75	mJ
Power Dissipation ⁽⁴⁾	P _D	T _C = 25°C	41
		T _C = 100°C	16.6
Junction & Storage Temperature Range	T _J , T _{STG}	-55 to 150	°C

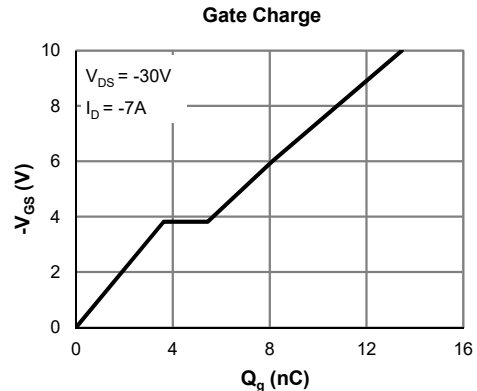
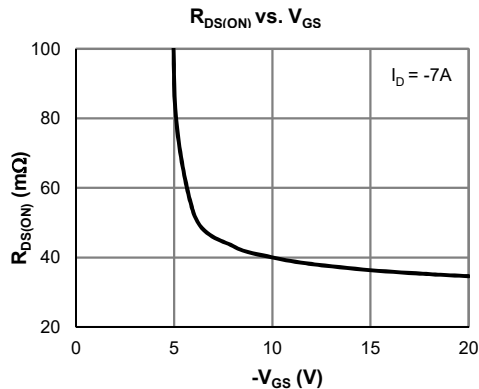



Electrical Characteristics (@ $T_J = 25^\circ\text{C}$ unless otherwise specified)

Parameter	Symbol	Conditions	Min.	Typ.	Max.	Unit
STATIC PARAMETERS						
Drain-Source Breakdown Voltage	$V_{(BR)DSS}$	$I_D = -250\mu\text{A}, V_{GS} = 0\text{V}$	-60			V
Zero Gate Voltage Drain Current	I_{DSS}	$V_{DS} = -48\text{V}, V_{GS} = 0\text{V}$ $T_J = 55^\circ\text{C}$			-1.0 -5.0	μA
Gate-Body Leakage Current	I_{GSS}	$V_{DS} = 0\text{V}, V_{GS} = \pm 20\text{V}$			± 100	nA
Gate Threshold Voltage	$V_{GS(th)}$	$V_{DS} = V_{GS}, I_D = -250\mu\text{A}$	-1.0	-2.0	-3.0	V
Static Drain-Source ON-Resistance	$R_{DS(on)}$	$V_{GS} = -10\text{V}, I_D = -7\text{A}$		40	50	$\text{m}\Omega$
		$V_{GS} = -4.5\text{V}, I_D = -5\text{A}$		55	72	$\text{m}\Omega$
Forward Transconductance	g_{FS}	$V_{DS} = -5\text{V}, I_D = -7\text{A}$		20		S
Diode Forward Voltage	V_{SD}	$I_S = -1\text{A}, V_{GS} = 0\text{V}$		-0.77	-1.0	V
Diode Continuous Current	I_S	$T_C = 25^\circ\text{C}$			-22	A
DYNAMIC PARAMETERS ⁽⁵⁾						
Input Capacitance	C_{iss}	$V_{GS} = 0\text{V}, V_{DS} = -30\text{V}, f = 1\text{MHz}$		855		pF
Output Capacitance	C_{oss}			189		pF
Reverse Transfer Capacitance	C_{rss}			9.5		pF
Gate Resistance	R_g	$V_{GS} = 0\text{V}, V_{DS} = 0\text{V}, f = 1\text{MHz}$		9.0		Ω
SWITCHING PARAMETERS ⁽⁵⁾						
Total Gate Charge (@ $V_{GS} = -10\text{V}$)	Q_g	$V_{GS} = 0 \text{ to } -10\text{V}$ $V_{DS} = -30\text{V}, I_D = -7\text{A}$		13.5		nC
Total Gate Charge (@ $V_{GS} = -4.5\text{V}$)	Q_g			6.4		nC
Gate Source Charge	Q_{gs}			3.6		nC
Gate Drain Charge	Q_{gd}			1.8		nC
Turn-On Delay Time	$t_{D(on)}$	$V_{GS} = -10\text{V}, V_{DS} = -30\text{V}$ $R_L = 4.3\Omega, R_{GEN} = 3\Omega$		5.4		ns
Turn-On Rise Time	t_r			1.9		ns
Turn-Off Delay Time	$t_{D(off)}$			23		ns
Turn-Off Fall Time	t_f			4.2		ns
Body Diode Reverse Recovery Time	t_{rr}		$I_F = -7\text{A}, dI_F/dt = -100\text{A}/\mu\text{s}$		27	
Body Diode Reverse Recovery Charge	Q_{rr}	$I_F = -7\text{A}, dI_F/dt = -100\text{A}/\mu\text{s}$		28		nC

Thermal Performance

Parameter	Symbol	Typ.	Max.	Unit
Thermal Resistance, Junction-to-Ambient	$R_{\theta JA}$	65	75	$^\circ\text{C}/\text{W}$
Thermal Resistance, Junction-to-Case	$R_{\theta JC}$	3.0	4.0	$^\circ\text{C}/\text{W}$

Notes:

1. Computed continuous current assumes the condition of T_{J_Max} while the actual continuous current depends on the thermal & electro-mechanical application board design.
2. This single-pulse measurement was taken under $T_{J_Max} = 150^\circ\text{C}$.
3. E_{AS} of 75 mJ is based on starting $T_J = 25^\circ\text{C}, L = 3.0\text{mH}, I_{AS} = -7.1\text{A}, V_{GS} = -10\text{V}, V_{DD} = -30\text{V}; 100\%$ test at $L = 0.1\text{mH}, I_{AS} = -25\text{A}, T_{J_Max} = 150^\circ\text{C}$.
4. The power dissipation P_D is based on $T_{J_Max} = 150^\circ\text{C}$.
5. This value is guaranteed by design hence it is not included in the production test.

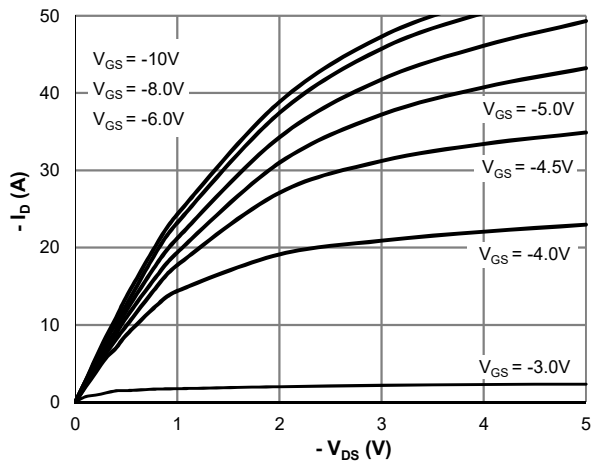
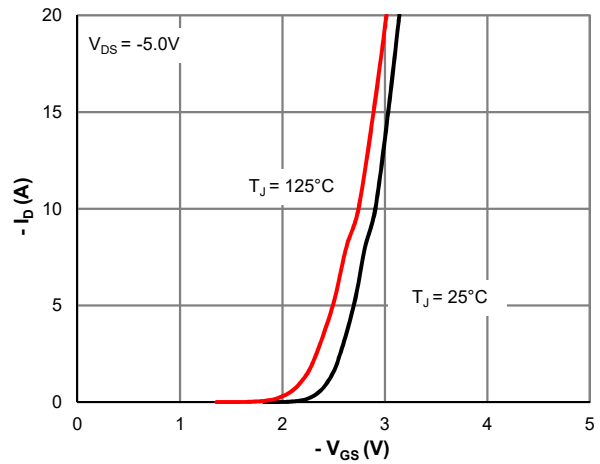
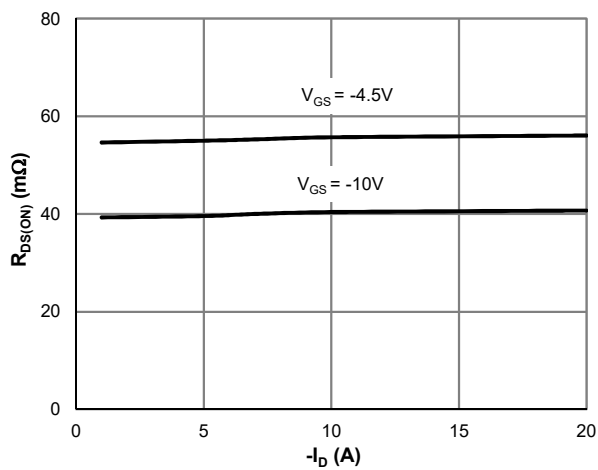
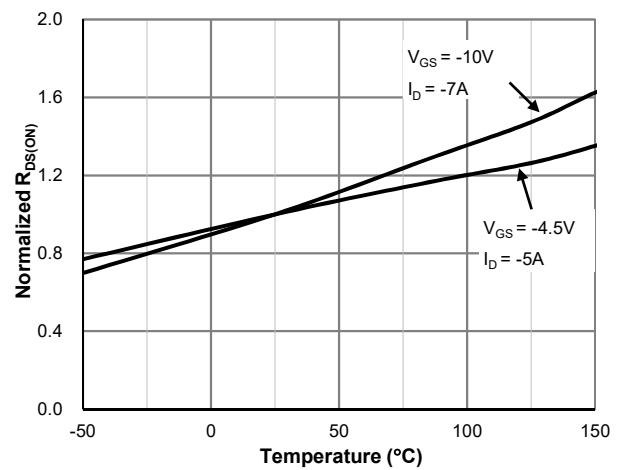
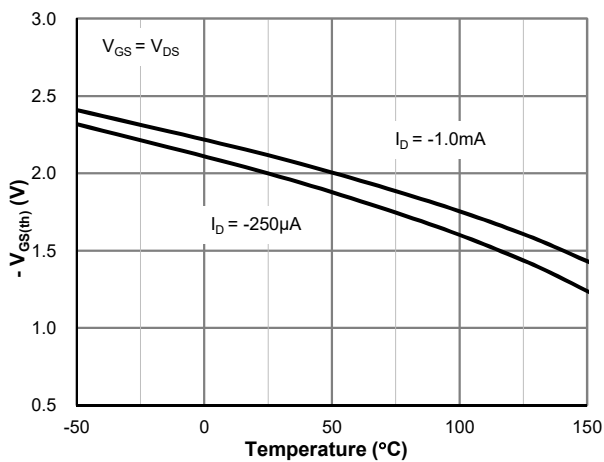
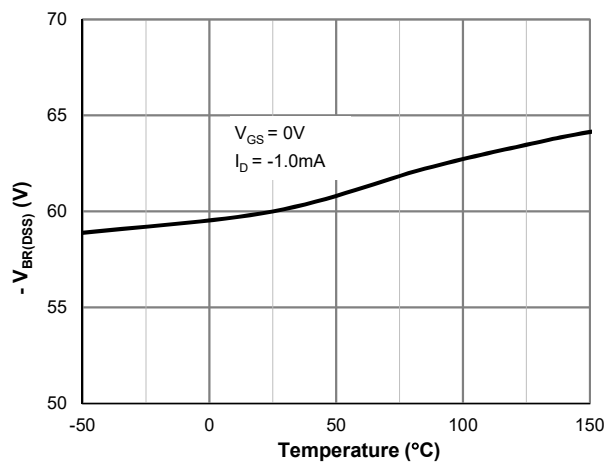
Typical Electrical & Thermal Characteristics

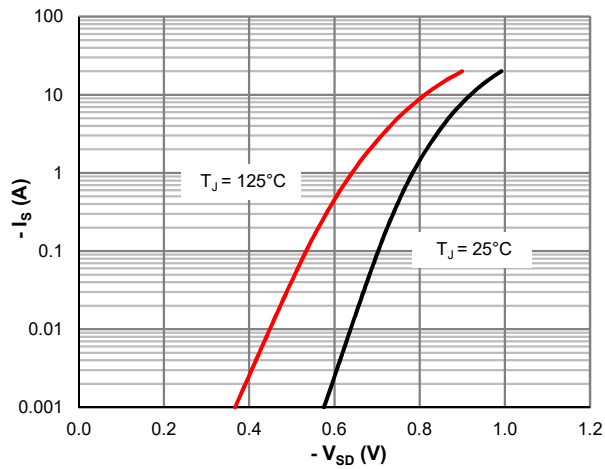
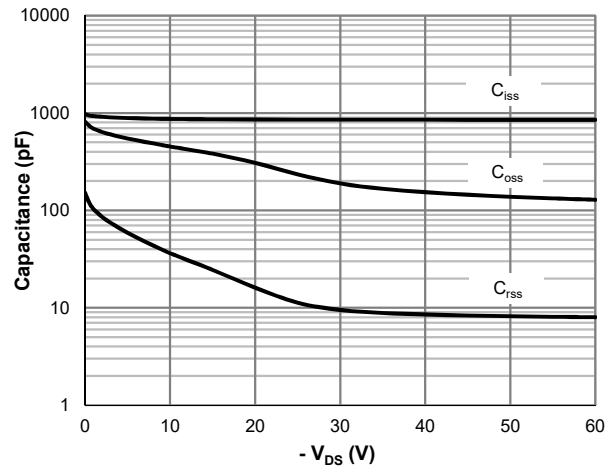
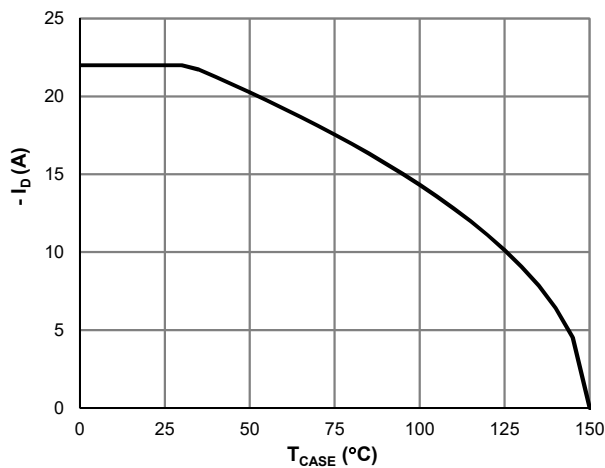
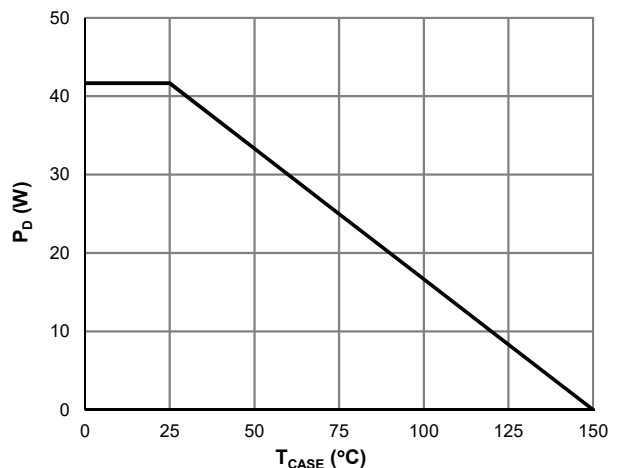
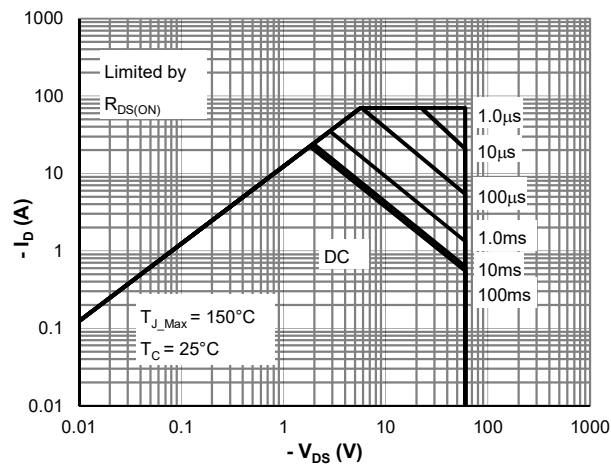
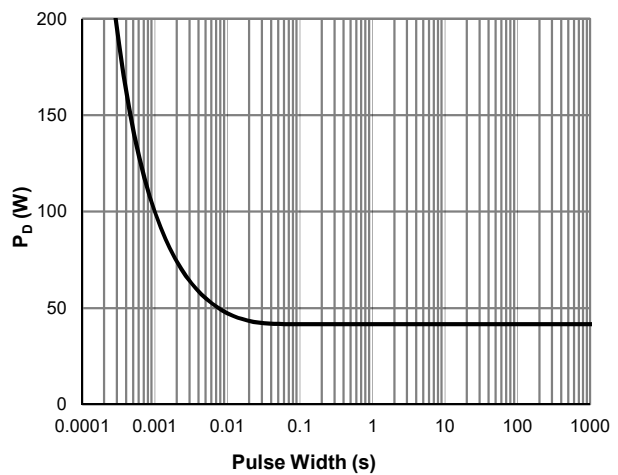
Figure 1: Saturation Characteristics

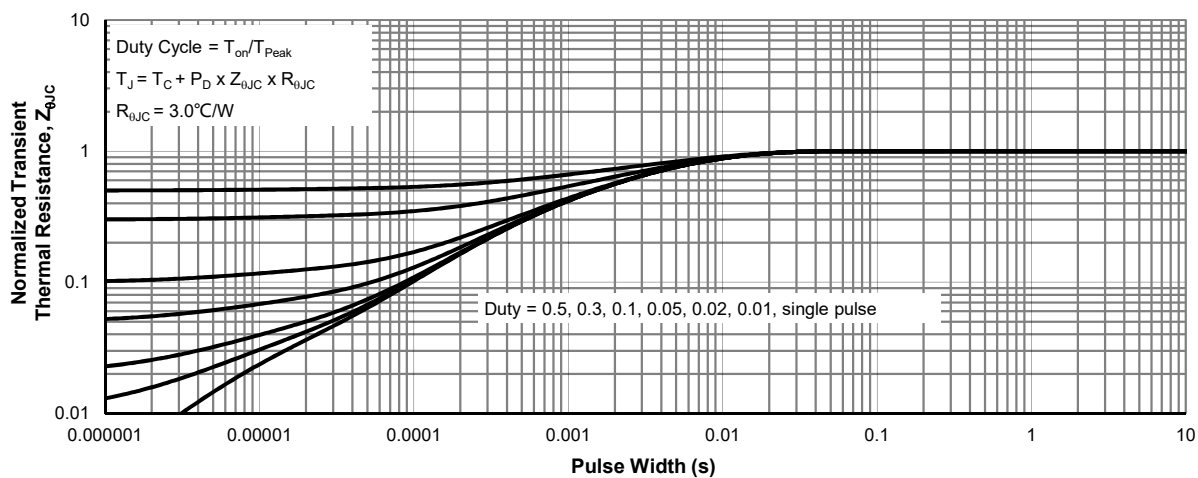
Figure 2: Transfer Characteristics

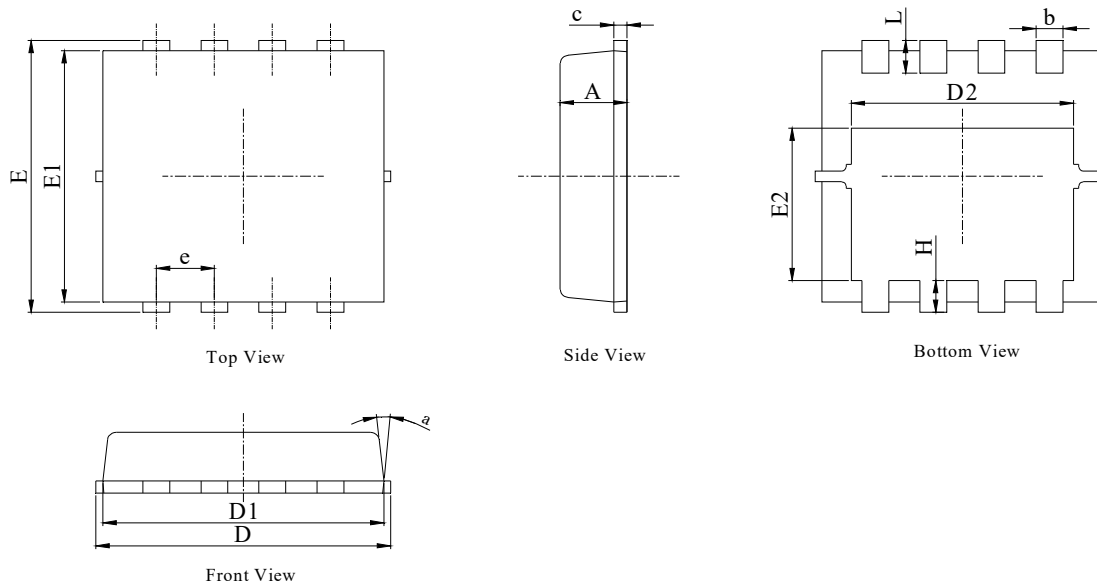
Figure 3: $R_{DS(ON)}$ vs. Drain Current

Figure 4: $R_{DS(ON)}$ vs. Junction Temperature

Figure 5: $V_{GS(th)}$ vs. Junction Temperature

Figure 6: $V_{BR(DSS)}$ vs. Junction Temperature

Typical Electrical & Thermal Characteristics

Figure 7: Body-Diode Characteristics

Figure 8: Capacitance Characteristics

Figure 9: Current De-rating

Figure 10: Power De-rating

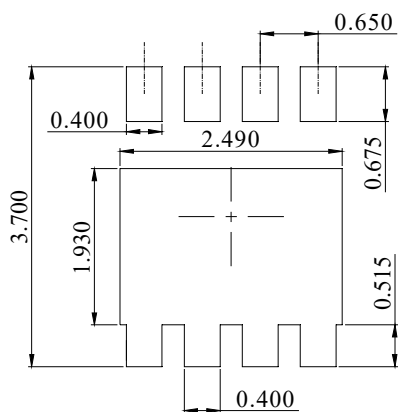
Figure 11: Maximum Safe Operating Area

Figure 12: Single Pulse Power Rating, Junction-to-Case

Typical Electrical & Thermal Characteristics

Figure 13: Normalized Maximum Transient Thermal Impedance

PDFN3x3-8L Package Information
Package Outline

NOTES:

1. DIMENSIONING AND TOLERANCING PER ASME Y14.5M,1994.
2. ALL DIMNESIONS IN MILLIMETER (ANNGLE IN DEGREE).
3. DIMENSIONS D1 AND E1 DO NOT INCLUDE MOLD FLASH PROTRUSIONS OR GATE BURRS.

DIM.	MILLIMETER		
	MIN.	NOM.	MAX.
A	0.70	0.75	0.80
b	0.25	0.30	0.35
c	0.10	0.20	0.25
D	3.00	3.15	3.25
D1	2.95	3.05	3.15
D2	2.39	2.49	2.59
E	3.20	3.30	3.40
E1	2.95	3.05	3.15
E2	1.70	1.80	1.90
e	0.65 BSC		
H	0.30	0.40	0.50
L	0.25	0.40	0.50
a	---	---	15°

Recommended Soldering Footprint

DIMENSIONS:MILLIMETERS